



**TAG**

# Fleet Catalogue

April 2024

TAG Towbars are designed, manufactured and tested to comply with ADR62/01 standards.  
Towbars are rated to the vehicle's maximum towing capacity. Failure to monitor load limits and tow ball weights can lead to serious instability of towing vehicle and caravan.

TAG Towbars are proudly manufactured in Queensland, Australia. Copyright TAG Towbar 2024. All Rights Reserved.  
BRINK is a registered trade mark of Brink Towing Systems B.V. Netherlands. All Rights Reserved.

[tagtowbars.com.au](https://tagtowbars.com.au)

# Ford Everest Next-Gen

2

T7F860



## Heavy Duty (3-Piece) SUV

(06/2022 - on)

- 3-Piece Design for easier installation
- Class 4 Towbar - 50mm Square Hitch Receiver
- Durable Powder Coated Finish
- TAG Limited Lifetime Warranty
- Towbar includes Tow Ball, Tow Ball Mount, Pin & Clip and D-Shackles

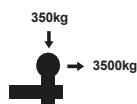

**TAG HD**

TXR861



## 4x4 Recovery SUV

(06/2022 - on)

- Extreme Duty Reinforced Crossbar
- Two WLL 4000kg Load-Rated Recovery Points integrated into our 3-Piece Design side-arms with bevelled edges to suit soft-shackles.
- Flush chassis-mounted profile for maximum offroad clearance for improved departure angles.
- Textured Powder Coated Finish
- Dual top-mounted Trailer & Anderson Plug Mounts
- Class 4 Towbar - 50mm Square Hitch Receiver
- TAG Limited Lifetime Warranty
- Includes Zinc Tow Ball & Extreme Duty Drop Hitch rated at 3500kg towing capacity / 350kg ball weight, Pin & Clip and D-Shackles

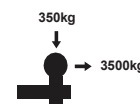

**TAG XR**

# Ford Ranger Next-Gen

3

T7F838



## Heavy Duty (3-Piece) Styleside Ute (06/2022 - on)

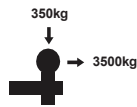

- 3-Piece Design
- Factory Mounting Points for ease of fitment
- Durable Powder Coated Finish
- Class 4, 50mm x 50mm Hitch Receiver
- TAG Limited Lifetime Warranty
- Includes Tow Ball, Tow Ball Mount, Pin & Clip and D-Shackles

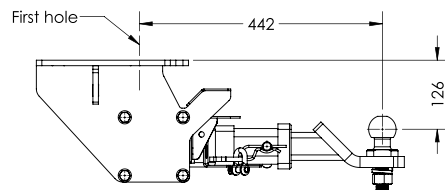

**TAG**

T7F841



## Heavy Duty (3-Piece) Cab Chassis (06/2022 - on)

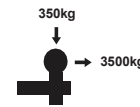

- 3-Piece Design
- Factory Mounting Points for ease of fitment
- Durable Powder Coated Finish
- Class 4, 50mm x 50mm Hitch Receiver
- TAG Limited Lifetime Warranty
- Includes Extreme Duty Drop Hitch Tow Ball, Tow Ball Mount, Pin & Clip and D-Shackles

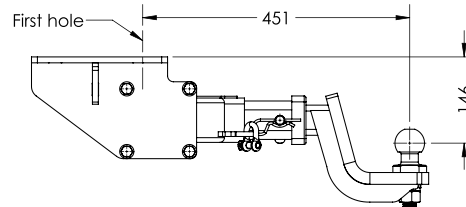

**TAG**

T7F840



## Heavy Duty (3-Piece) Extended Tray (06/2022 - on)

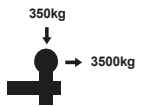

- 3-Piece Design (Suits Extended Tray or Canopy)
- Factory Mounting Points for ease of fitment
- Class 4, 50mm x 50mm Hitch Receiver
- Durable Powder Coated Finish
- TAG Limited Lifetime Warranty
- Includes Tow Ball, Tow Ball Mount, Pin & Clip and D-Shackles

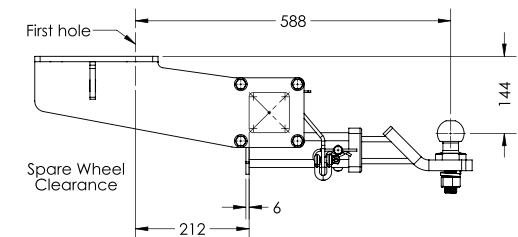

**TAG**

# Ford Ranger Next-Gen

4

TXR836



## 4x4 Recovery Cab Chassis

(06/2022 - on)

- 89mm x 89mm Extreme Duty Reinforced Crossbar
- Two WLL 4500kg Load-Rated Recovery Points
- Maximum clearance for departure angles.
- Textured Extreme Duty Powder Coated Finish
- Dual top-mounted Trailer & Anderson Plug Mounts
- TAG Limited Lifetime Warranty
- Includes Zinc Tow Ball & Extreme Duty Drop Hitch, Pin & Clip and D-Shackles

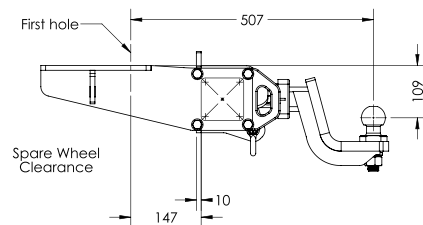
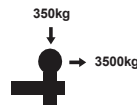

**TAG XR**

TXR843



## 4x4 Recovery Styleside Ute

(06/2022 - on)

- Extreme Duty Reinforced Crossbar
- Two WLL 4500kg Load-Rated Recovery Points
- Maximum clearance for departure angles.
- Textured Extreme Duty Powder Coated Finish
- Dual top-mounted Trailer & Anderson Plug Mounts
- TAG Limited Lifetime Warranty
- Includes Zinc Tow Ball & Tow Ball Mount, Pin & Clip and D-Shackles

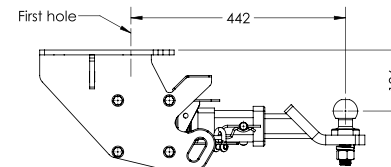
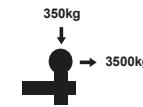

**TAG XR**



# Ford Ranger

5

T7F704



## Heavy Duty (3-Piece)

### Styleside Ute

(09/2011 - 05/2022)

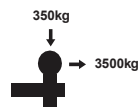

- 3-Piece Design
- Factory Mounting Points for ease of fitment
- Durable Powder Coated Finish
- Class 4, 50mm x 50mm Hitch Receiver
- TAG Limited Lifetime Warranty
- Includes Tow Ball, Tow Ball Mount, Pin & Clip and D-Shackles

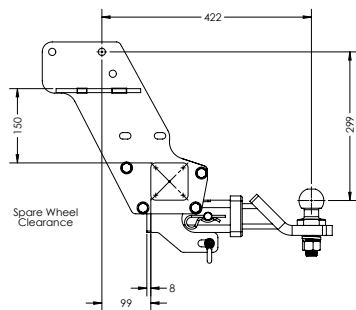

**TAG HD**

T7F705



## Heavy Duty (3-Piece)

### Cab Chassis

(09/2011 - 05/2022)

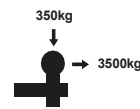

- 3-Piece Design
- Factory Mounting Points for ease of fitment
- Durable Powder Coated Finish
- Class 4, 50mm x 50mm Hitch Receiver
- TAG Limited Lifetime Warranty
- Includes Tow Ball, Tow Ball Mount, Pin & Clip and D-Shackles

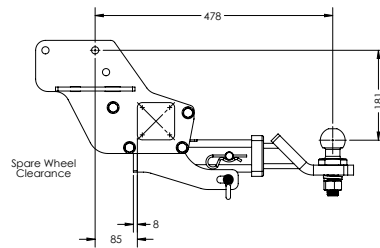

**TAG HD**

T7F706



## Heavy Duty (3-Piece)

### Extended Tray

(09/2011 - 05/2022)

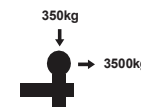

- 3-Piece Design (Suits Extended Tray or Canopy)
- Class 4, 50mm x 50mm Hitch Receiver
- Durable Powder Coated Finish
- TAG Limited Lifetime Warranty
- Includes Tow Ball, Tow Ball Mount, Pin & Clip and D-Shackles

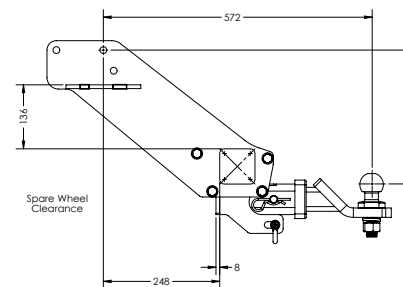

**TAG HD**

TXR804



## 4x4 Recovery

### Cab Chassis

(09/2011 - 02/2022)

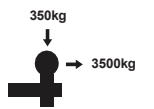

- 89mm x 89mm Extreme Duty Reinforced Crossbar
- Two WLL 4500kg Load-Rated Recovery Points
- Maximum clearance for departure angles.
- Textured Extreme Duty Powder Coated Finish
- Dual top-mounted Trailer & Anderson Plug Mounts
- TAG Limited Lifetime Warranty
- Includes Zinc Tow Ball & Extreme Duty Drop Hitch, Pin & Clip and D-Shackles

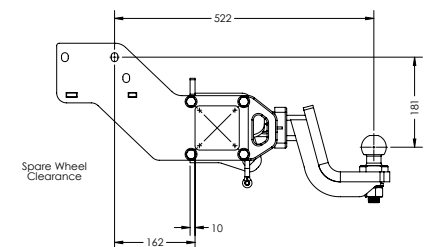

**TAG XR**

# Ford Transit

6

T7F780



## Heavy Duty (3-Piece) Van

(02/2014 - on)

- 3-Piece Design for easier installation
- Durable Powder Coated Finish
- Class 4, 50mm x 50mm Hitch Receiver
- TAG Limited Lifetime Warranty
- Includes Tow Ball, Tow Ball Mount, Pin & Clip and D-Shackles

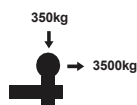

**TAG** HD

T7F781-K010



## Towbar & Rear Step Van

(02/2014 - on)

- 3-Piece Design
- Factory Mounting Points for ease of fitment
- Bolt-on Galvanised Rear Step
- Sensor Bracket Kit
- Powder Coated Towbar and Brackets
- Class 4, 50mm x 50mm Hitch Receiver
- TAG Limited Lifetime Warranty
- Includes Tow Ball, Tow Ball Mount, Pin & Clip and D-Shackles

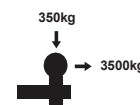

**TAG** HD

TSF782-K010



## Rear Step Van

(02/2014 - on)

- Bolt-on Galvanised Rear Step
- Sensor Bracket Kit
- Heavy-Duty Powder-Coated Brackets
- 250kg Static Load Rating
- TAG Limited Lifetime Warranty

# Ford Transit Custom

7

T7F759



## Heavy Duty (3-Piece)

### Van

(05/2014 - on)

- 3-Piece Design
- Factory Mounting Points for ease of fitment
- Durable Powder Coated Finish
- Class 4, 50mm x 50mm Hitch Receiver
- TAG Limited Lifetime Warranty
- Includes Tow Ball, Tow Ball Mount, Pin & Clip and D-Shackles

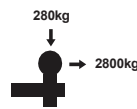

T7F742-K010



## Towbar & Rear Step

### Van

(02/2014 - on)

- 3-Piece Design
- Factory Mounting Points for ease of fitment
- Bolt-on Galvanised Rear Step
- Sensor Bracket Kit
- Powder Coated Towbar and Brackets
- Class 4, 50mm x 50mm Hitch Receiver
- TAG Limited Lifetime Warranty
- Includes Tow Ball, Tow Ball Mount, Pin & Clip and D-Shackles

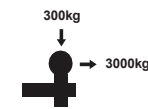

TSF750-K010



## Rear Step

### Van

(03/2013 - on)

- Bolt-on Galvanised Rear Step
- Sensor Bracket Kit
- Heavy-Duty Powder-Coated Brackets
- 250kg Static Load Rating
- TAG Limited Lifetime Warranty

# Great Wall Cannon

8

T4G839



## Heavy Duty (1-Piece) Styleside / Cab Chassis (09/2020 - on)

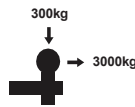

- Factory Mounting Points for ease of fitment
- Durable Powder Coated Finish
- Class 4, 50mm x 50mm Hitch Receiver
- TAG Limited Lifetime Warranty
- Includes Tow Ball, Tow Ball Mount, Pin & Clip and D-Shackles

**TAG HD**

T7G779



## Heavy Duty (3-Piece) Styleside / Cab Chassis (09/2020 - on)

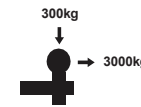

- 3-Piece Design
- Factory Mounting Points for ease of fitment
- Durable Powder Coated Finish
- Class 4, 50mm x 50mm Hitch Receiver
- TAG Limited Lifetime Warranty
- Includes Tow Ball, Tow Ball Mount, Pin & Clip and D-Shackles

**TAG HD**

TXR851



## 4x4 Recovery Styleside / Cab Chassis (09/2020 - on)

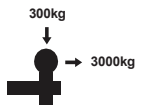

- Extreme Duty Reinforced Crossbar
- Two WLL 4000kg Load-Rated Recovery Points integrated into our 3-Piece Design side-arms with bevelled edges to suit soft-shackles.
- Flush chassis-mounted profile for maximum offroad clearance for improved departure angles.
- Textured Powder Coated Finish
- Dual top-mounted Trailer & Anderson Plug Mounts
- Class 4 Towbar - 50mm Square Hitch Receiver
- TAG Limited Lifetime Warranty
- Includes Zinc Tow Ball & Extreme Duty Drop Hitch rated at 3500kg towing capacity / 350kg ball weight, Pin & Clip and D-Shackles

**TAG XR**

# Hyundai iLoad

9

T7Z726



## Heavy Duty (3-Piece)

### Van

(01/2008 - on)

- 3-Piece Design
- Factory Mounting Points for ease of fitment
- Durable Powder Coated Finish
- Class 4, 50mm x 50mm Hitch Receiver
- TAG Limited Lifetime Warranty
- Includes Tow Ball, Tow Ball Mount, Pin & Clip and D-Shackles

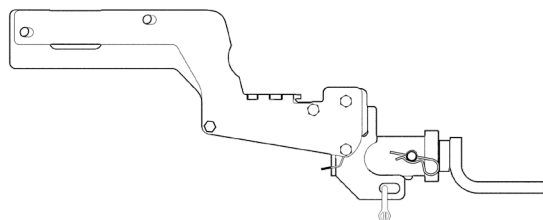
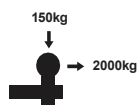

**TAG**

T7Z737-K010



## Towbar & Rear Step

### Van

(01/2008 - on)

- 3-Piece Design
- Factory Mounting Points for ease of fitment
- Bolt-on Galvanised Rear Step
- Powder Coated Towbar and Brackets
- Class 4, 50mm x 50mm Hitch Receiver
- TAG Limited Lifetime Warranty
- Includes Tow Ball, Tow Ball Mount, Pin & Clip and D-Shackles

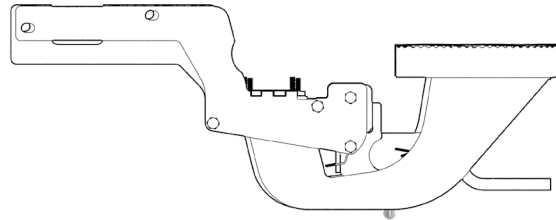
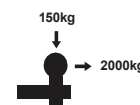

**TAG**

TSZ745-K010



## Rear Step

### Van

(01/2008 - on)

- Bolt-on Galvanised Rear Step
- Heavy-Duty Powder-Coated Brackets
- 250kg Static Load Rating
- TAG Limited Lifetime Warranty

# Hyundai Staria

10

T7Z828



## Heavy Duty (3-Piece)

### Van

(01/2021 - on)

- 3-Piece Design
- Factory Mounting Points for ease of fitment
- Durable Powder Coated Finish
- Class 4, 50mm x 50mm Hitch Receiver
- TAG Limited Lifetime Warranty
- Includes Tow Ball Mount, Pin & Clip and D-Shackles

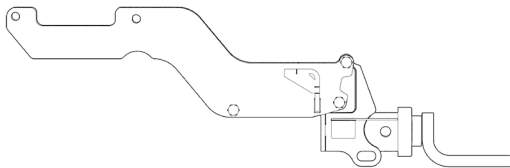
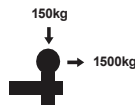

**TAG**

T7Z829-K010

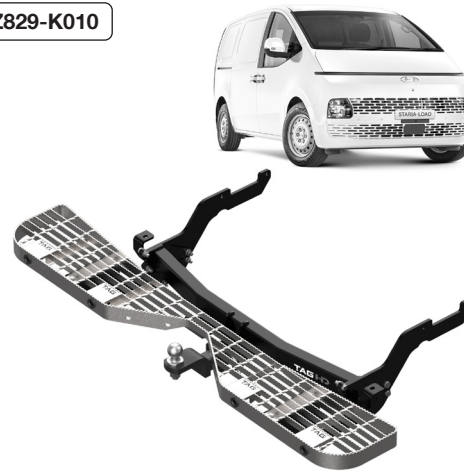

## Towbar & Rear Step

### Van

(01/2021 - on)

- 3-Piece Design
- Factory Mounting Points for ease of fitment
- Bolt-on Galvanised Rear Step
- Sensor Bracket Kit
- Powder Coated Towbar and Brackets
- Class 4, 50mm x 50mm Hitch Receiver
- TAG Limited Lifetime Warranty
- Includes Tow Ball, Tow Ball Mount, Pin & Clip and D-Shackles

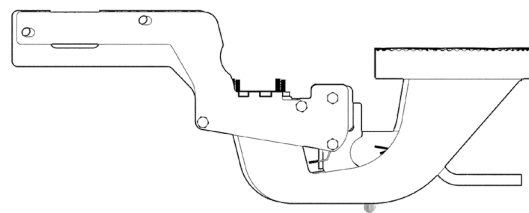
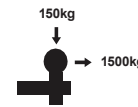

**TAG**

TSZ830-K010

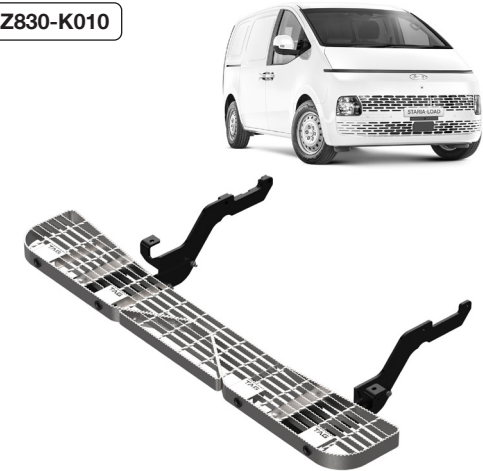

## Rear Step

### Van

(01/2021 - on)

- Bolt-on Galvanised Rear Step
- Sensor Bracket Kit
- Heavy-Duty Powder-Coated Brackets
- 250kg Static Load Rating
- TAG Limited Lifetime Warranty



# Isuzu D-MAX

11

T7H765



T7H770



TXR800



TXR822



## Heavy Duty (3-Piece) Styleside / Cab Chassis (07/2020 - on)

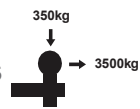

- 3-Piece Design
- Factory Mounting Points for ease of fitment
- Durable Powder Coated Finish
- Class 4, 50mm x 50mm Hitch Receiver
- TAG Limited Lifetime Warranty
- Includes Tow Ball, Tow Ball Mount, Pin & Clip and D-Shackles

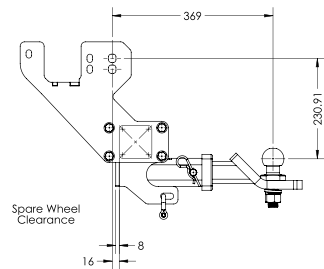

**TAG HD**

## Heavy Duty (3-Piece) Extended Tray (06/2020 - on)

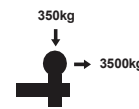

- 3-Piece Design (Suits Extended Tray or Canopy)
- Class 4, 50mm x 50mm Hitch Receiver
- Durable Powder Coated Finish
- TAG Limited Lifetime Warranty
- Includes Tow Ball, Tow Ball Mount, Pin & Clip and D-Shackles

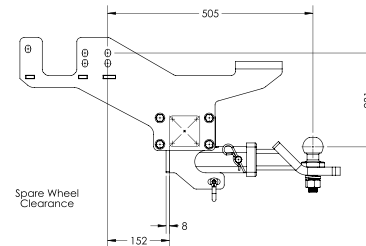

**TAG HD**

## 4x4 Recovery Cab Chassis (07/2020 - on)

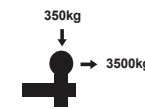

- 89mm x 89mm Extreme Duty Reinforced Crossbar
- Two WLL 4500kg Load-Rated Recovery Points
- Maximum clearance for departure angles.
- Textured Extreme Duty Powder Coated Finish
- Dual top-mounted Trailer & Anderson Plug Mounts
- TAG Limited Lifetime Warranty
- Includes Zinc Tow Ball & Extreme Duty Drop Hitch, Pin & Clip and D-Shackles

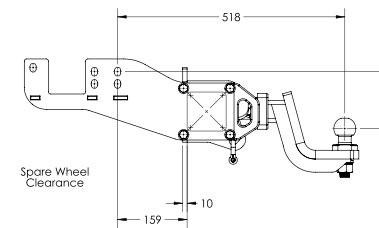

**TAG XR**

## 4x4 Recovery Styleside Ute (06/2020 - on)

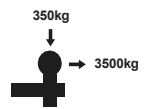

- Two WLL 4500kg Load-Rated Recovery Points
- Maximum clearance for departure angles.
- Textured Extreme Duty Powder Coated Finish
- TAG Limited Lifetime Warranty
- Includes Zinc Tow Ball & Extreme Duty Drop Hitch, Pin & Clip and D-Shackles

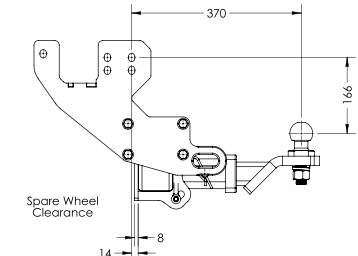

**TAG XR**

T7H808



## Heavy Duty (3-Piece) SUV

(06/2021 - on)

- 3-Piece Design
- Factory Mounting Points for ease of fitment
- Durable Powder Coated Finish
- Class 4, 50mm x 50mm Hitch Receiver
- TAG Limited Lifetime Warranty
- Includes Tow Ball, Tow Ball Mount, Pin & Clip and D-Shackles

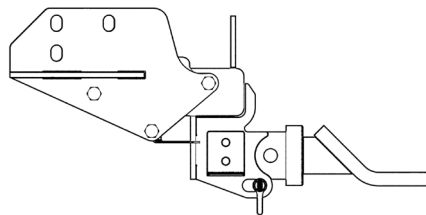
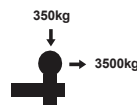

**TAG HD**

TXR832



## 4x4 Recovery SUV

(06/2021 - on)

- Updated design to cater for larger tyres (265/70R17)
- Extreme Duty Reinforced Crossbar
- Two WLL 4000kg Load-Rated Recovery Points integrated into our 3-Piece Design side-arms with bevelled edges to suit soft shackles.
- Flush chassis-mounted profile for maximum offroad clearance
- Dual top-mounted Trailer & Anderson Plug Mounts
- TAG Limited Lifetime Warranty
- Includes Zinc Tow Ball & Extreme Duty Drop Hitch rated at 3500kg towing capacity / 350kg ball weight, Pin & Clip and D-Shackles

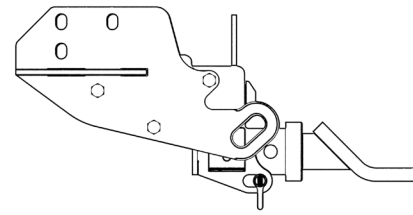
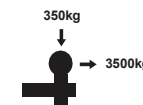

**TAG XR**

T7P760



## Heavy Duty (3-Piece) Van

(06/2015 - on)

- 3-Piece Design
- Factory Mounting Points for ease of fitment
- Durable Powder Coated Finish
- Class 4, 50mm x 50mm Hitch Receiver
- TAG Limited Lifetime Warranty
- Includes Tow Ball, Tow Ball Mount, Pin & Clip and D-Shackles

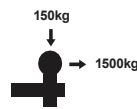

T7P744-K010



## Towbar & Rear Step Van

(04/2015 - on)

- 3-Piece Design
- Factory Mounting Points for ease of fitment
- Bolt-on Galvanised Rear Step
- Sensor Bracket Kit
- Powder Coated Towbar and Brackets
- Class 4, 50mm x 50mm Hitch Receiver
- TAG Limited Lifetime Warranty
- Includes Tow Ball, Tow Ball Mount, Pin & Clip and D-Shackles

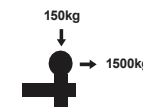

TSP752-K010



## Rear Step Van

(04/2015 - on)

- Bolt-on Galvanised Rear Step
- Sensor Bracket Kit
- Heavy-Duty Powder-Coated Brackets
- 250kg Static Load Rating
- TAG Limited Lifetime Warranty

# LDV T60 / T60 Max

14

T4P660



## Heavy Duty (1-Piece) Styleside Ute (07/2017 - on)

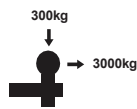

- Fits all variants of T60 including Cab Chassis and Megatub.
- Class 4 Towbar - 50mm Square Hitch Receiver
- Durable Enamel Immersion Dipped Finish
- TAG Limited Lifetime Warranty
- Towbar includes Tow Ball, Tow Ball Mount, Pin & Clip and D-Shackles
- Spacers included with Towbar to suit 2024 model

**TAG HD**

T7P702



## Heavy Duty (3-Piece) Styleside / Cab Chassis (07/2017 - on)

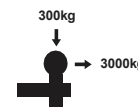

- Fits all variants of T60 including Cab Chassis and Megatub.
- 3-Piece Design for easier installation
- Class 4 Towbar - 50mm Square Hitch Receiver
- Durable Powder Coated Finish
- TAG Limited Lifetime Warranty
- Towbar includes Tow Ball, Tow Ball Mount, Pin & Clip and D-Shackles

**TAG HD**

TXR868



## 4x4 Recovery Styleside Ute (07/2017 - on)

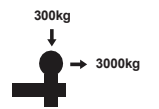

- Fits all variants of T60 including Cab Chassis and Megatub.
- Extreme Duty Reinforced Crossbar
- Two WLL 4000kg Load-Rated Recovery Points integrated into our 3-Piece Design side-arms with bevelled edges to suit soft-shackles.
- Flush chassis-mounted profile for maximum offroad clearance for improved departure angles.
- Textured Powder Coated Finish
- Dual top-mounted Trailer & Anderson Plug Mounts
- Class 4 Towbar - 50mm Square Hitch Receiver
- TAG Limited Lifetime Warranty
- Includes Zinc Tow Ball & Extreme Duty Drop Hitch rated at 3500kg towing capacity / 350kg ball weight, Pin & Clip and D-Shackles
- Spacers included with Towbar to suit 2024 model

**TAG XR**

# Mazda BT-50

15

T7H765



## Heavy Duty (3-Piece) Styleside / Cab Chassis (08/2020 - on)

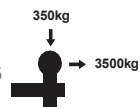

- 3-Piece Design
- Factory Mounting Points for ease of fitment
- Durable Powder Coated Finish
- Class 4, 50mm x 50mm Hitch Receiver
- TAG Limited Lifetime Warranty
- Includes Tow Ball, Tow Ball Mount, Pin & Clip and D-Shackles

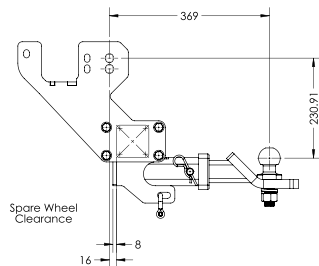

**TAG HD**

T7H770



## Heavy Duty (3-Piece) Extended Tray (07/2020 - on)

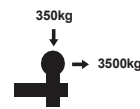

- 3-Piece Design (Suits Extended Tray or Canopy)
- Class 4, 50mm x 50mm Hitch Receiver
- Durable Powder Coated Finish
- TAG Limited Lifetime Warranty
- Includes Tow Ball, Tow Ball Mount, Pin & Clip and D-Shackles

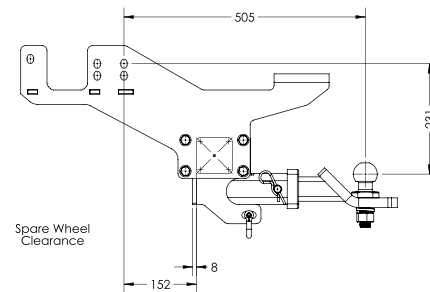

**TAG HD**

TXR800



## 4x4 Recovery Cab Chassis (07/2020 - on)

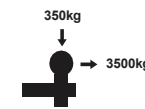

- 89mm x 89mm Extreme Duty Reinforced Crossbar
- Two WLL 4500kg Load-Rated Recovery Points
- Maximum clearance for departure angles.
- Textured Extreme Duty Powder Coated Finish
- Dual top-mounted Trailer & Anderson Plug Mounts
- TAG Limited Lifetime Warranty
- Includes Zinc Tow Ball & Extreme Duty Drop Hitch, Pin & Clip and D-Shackles

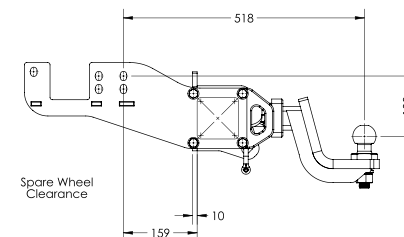

**TAG XR**

TXR822



## 4x4 Recovery Styleside Ute (07/2020 - on)

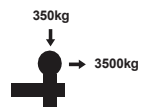

- Extreme Duty Reinforced Crossbar
- Two WLL 4500kg Load-Rated Recovery Points
- Maximum clearance for departure angles.
- Textured Extreme Duty Powder Coated Finish
- Dual top-mounted Trailer & Anderson Plug Mounts
- TAG Limited Lifetime Warranty
- Includes Zinc Tow Ball & Extreme Duty Drop Hitch, Pin & Clip and D-Shackles

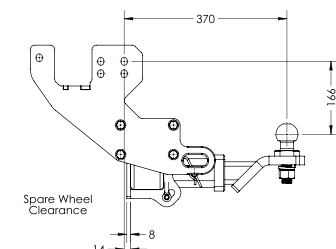

**TAG XR**

# Mercedes-Benz Sprinter

16

TSP754-K010



## Rear Step Van / Cab Chassis (02/2018 - on)

- Bolt-on Galvanised Rear Step
- Sensor Bracket Kit
- Heavy-Duty Powder-Coated Brackets
- 250kg Static Load Rating
- TAG Limited Lifetime Warranty



# Mitsubishi Outlander / Pajero Sport

17

T7C856



Outlander

## Heavy Duty (3-Piece) SUV

(06/2021 - on)

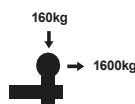

- 3-Piece Design
- Factory Mounting Points for ease of fitment
- Durable Powder Coated Finish
- Class 4, 50mm x 50mm Hitch Receiver
- TAG Limited Lifetime Warranty
- Includes Tow Ball, Tow Ball Mount, Pin & Clip and D-Shackles

**TAG HD**

T7C811



Pajero Sport

## Heavy Duty (3-Piece) SUV

(11/2019 - on)

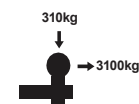

- 3-Piece Design
- Factory Mounting Points for ease of fitment
- Durable Powder Coated Finish
- Class 4, 50mm x 50mm Hitch Receiver
- TAG Limited Lifetime Warranty
- Includes Tow Ball, Tow Ball Mount, Pin & Clip and D-Shackles

**TAG HD**

TXR847



Pajero Sport

## 4x4 Recovery SUV

(11/2019 - on)



- Extreme Duty Reinforced Crossbar
- Two WLL 4000kg Load-Rated Recovery Points
- Maximum clearance for departure angles.
- Textured Extreme Duty Powder Coated Finish
- Dual top-mounted Trailer & Anderson Plug Mounts
- TAG Limited Lifetime Warranty
- Includes Zinc Tow Ball & Extreme Duty Drop Hitch, Pin & Clip and D-Shackles

**TAG XR**

# Mitsubishi Triton

18

T7C707



## Heavy Duty (3-Piece) Styleside Ute (05/2015 - on)

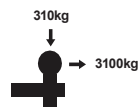

- Suits Models WITH Rear Bumper/Step
- 3-Piece Design
- Factory Mounting Points for ease of fitment
- Durable Powder Coated Finish
- Class 4, 50mm x 50mm Hitch Receiver
- TAG Limited Lifetime Warranty
- Includes Tow Ball, Tow Ball Mount, Pin & Clip and D-Shackles

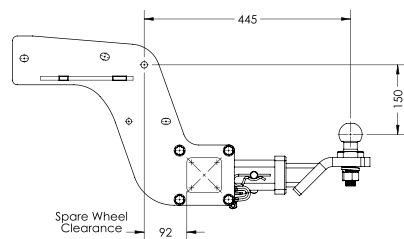

**TAG HD**

T7C708



No Bumper

## Heavy Duty (3-Piece) Styleside / Cab Chassis (11/2014 - on)

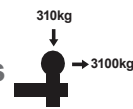

- Suits Models with Trayback and Styleside WITHOUT Rear Bumper/Step
- 3-Piece Design (Suits Extended Tray or Canopy)
- Class 4, 50mm x 50mm Hitch Receiver
- Durable Powder Coated Finish
- TAG Limited Lifetime Warranty
- Includes Tow Ball, Tow Ball Mount, Pin & Clip and D-Shackles

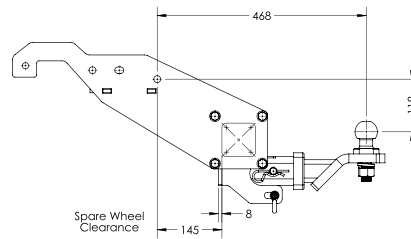

**TAG HD**

TXR805



## 4x4 Recovery Cab Chassis (01/2015 - on)

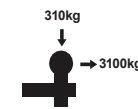

- 89mm x 89mm Extreme Duty Reinforced Crossbar
- Two WLL 4500kg Load-Rated Recovery Points
- Maximum clearance for departure angles.
- Textured Extreme Duty Powder Coated Finish
- Dual top-mounted Trailer & Anderson Plug Mounts
- TAG Limited Lifetime Warranty
- Includes Zinc Tow Ball & Extreme Duty Drop Hitch, Pin & Clip and D-Shackles

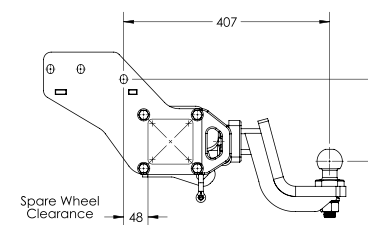

**TAG XR**

TXR850



## 4x4 Recovery Styleside Ute (05/2015 - on)

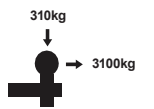

- Extreme Duty Reinforced Crossbar
- Two WLL 4000kg Load-Rated Recovery Points
- Maximum clearance for departure angles.
- Textured Extreme Duty Powder Coated Finish
- Dual top-mounted Trailer & Anderson Plug Mounts
- TAG Limited Lifetime Warranty
- Includes Zinc Tow Ball & Extreme Duty Drop Hitch, Pin & Clip and D-Shackles



**TAG XR**

T7D788



## Heavy Duty (3-Piece) Styleside / Cab Chassis (12/2020 - on)

- 3-Piece Design
- Factory Mounting Points for ease of fitment
- Durable Powder Coated Finish
- Class 4, 50mm x 50mm Hitch Receiver
- TAG Limited Lifetime Warranty
- Includes Tow Ball, Tow Ball Mount, Pin & Clip and D-Shackles

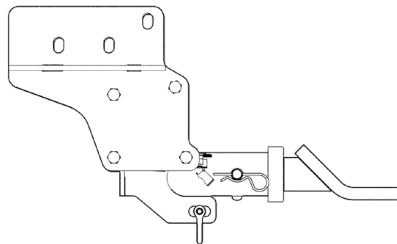
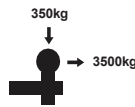

**TAG HD**

TXR806



## 4x4 Recovery Cab Chassis (03/2015 - on)

- 89mm x 89mm Extreme Duty Reinforced Crossbar
- Two WLL 4500kg Load-Rated Recovery Points
- Maximum clearance for departure angles.
- Textured Extreme Duty Powder Coated Finish
- Dual top-mounted Trailer & Anderson Plug Mounts
- TAG Limited Lifetime Warranty
- Includes Zinc Tow Ball & Extreme Duty Drop Hitch, Pin & Clip and D-Shackles

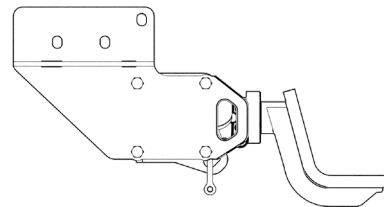
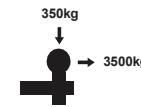

**TAG XR**

TXR849



## 4x4 Recovery Styleside Ute (02/2021 - on)

- Extreme Duty Reinforced Crossbar
- Two WLL 4000kg Load-Rated Recovery Points
- Maximum clearance for departure angles.
- Textured Extreme Duty Powder Coated Finish
- Dual top-mounted Trailer & Anderson Plug Mounts
- TAG Limited Lifetime Warranty
- Includes Zinc Tow Ball & Extreme Duty Drop Hitch, Pin & Clip and D-Shackles

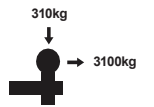

**TAG XR**

# Nissan Patrol

20

T7D762



## Heavy Duty (1-Piece) Wagon (12/2012 - on)

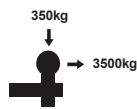

- Factory Mounting Points for ease of fitment
- Durable Powder Coated Finish
- Class 4, 50mm x 50mm Hitch Receiver
- TAG Limited Lifetime Warranty
- Includes Tow Ball, Tow Ball Mount, Pin & Clip and D-Shackles

**TAG HD**

TXR852



## 4x4 Recovery Wagon (12/2012 - on)

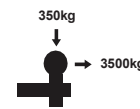

- Extreme Duty Reinforced Crossbar
- Two WLL 4000kg Load-Rated Recovery Points
- Maximum clearance for departure angles.
- Textured Extreme Duty Powder Coated Finish
- Dual top-mounted Trailer & Anderson Plug Mounts
- TAG Limited Lifetime Warranty
- Includes Zinc Tow Ball & Extreme Duty Drop Hitch, Pin & Clip and D-Shackles

**TAG XR**

# RAM 1500

21

T7P772



## Heavy Duty (3-Piece)

### Styleside Ute

(06/2018 - on)

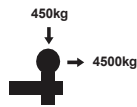

- 3-Piece Design
- Factory Mounting Points for ease of fitment
- Durable Powder Coated Finish
- Class 4, 50mm x 50mm Hitch Receiver
- TAG Limited Lifetime Warranty
- Includes Tow Ball Mount, Pin & Clip and D-Shackles



# Renault Master

22

T7P724



## Heavy Duty (3-Piece) Van / Cab Chassis (10/2011 - on)

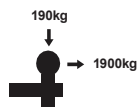

- 3-Piece Design
- Factory Mounting Points for ease of fitment
- Durable Powder Coated Finish
- Class 4, 50mm x 50mm Hitch Receiver
- TAG Limited Lifetime Warranty
- Includes Tow Ball Mount, Pin & Clip and D-Shackles

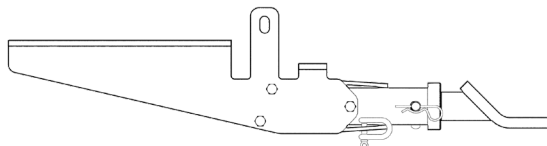

**TAG**

T7P739-K010

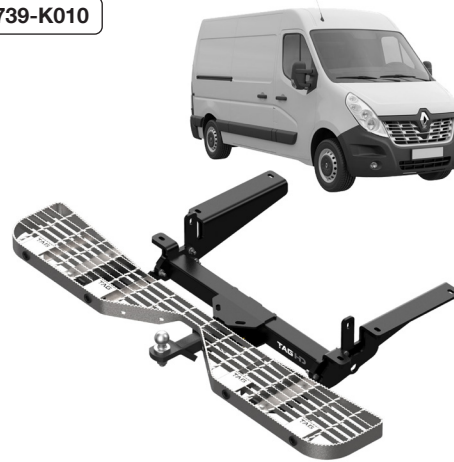

## Towbar & Rear Step Van / Cab Chassis (10/2011 - on)

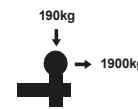

- 3-Piece Design
- Factory Mounting Points for ease of fitment
- Bolt-on Galvanised Rear Step
- Sensor Bracket Kit
- Powder Coated Towbar and Brackets
- Class 4, 50mm x 50mm Hitch Receiver
- TAG Limited Lifetime Warranty
- Includes Tow Ball, Tow Ball Mount, Pin & Clip and D-Shackles

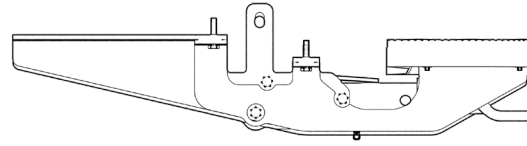

**TAG**

TSP747-K010



## Rear Step Van / Cab Chassis (10/2011 - on)

- Bolt-on Galvanised Rear Step
- Sensor Bracket Kit
- Heavy-Duty Powder-Coated Brackets
- 250kg Static Load Rating
- TAG Limited Lifetime Warranty



# Renault Trafic

23

T7P757



## Heavy Duty (3-Piece)

### Van

(05/2014 - on)

- 3-Piece Design
- Factory Mounting Points for ease of fitment
- Durable Powder Coated Finish
- Class 4, 50mm x 50mm Hitch Receiver
- TAG Limited Lifetime Warranty
- Includes Tow Ball Mount, Pin & Clip and D-Shackles

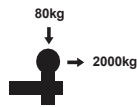

**TAG**

T7P740-K010



## Towbar & Rear Step

### Van

(05/2014 - on)

- 3-Piece Design
- Factory Mounting Points for ease of fitment
- Bolt-on Galvanised Rear Step
- Sensor Bracket Kit
- Powder Coated Towbar and Brackets
- Class 4, 50mm x 50mm Hitch Receiver
- TAG Limited Lifetime Warranty
- Includes Tow Ball, Tow Ball Mount, Pin & Clip and D-Shackles

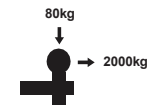

**TAG**

# Suzuki Jimny

24

TXR817



3 Door

## 4x4 Recovery SUV

(11/2018 - on)

- 65mm x 65mm Extreme Duty Reinforced Crossbar
- Two WLL 2000kg Load-Rated Recovery Points
- Maximum clearance for departure angles.
- Textured Extreme Duty Powder Coated Finish
- Dual top-mounted Trailer & Anderson Plug Mounts
- TAG Limited Lifetime Warranty
- Includes Zinc Tow Ball & Extreme Duty Drop Hitch, Pin & Clip and D-Shackles

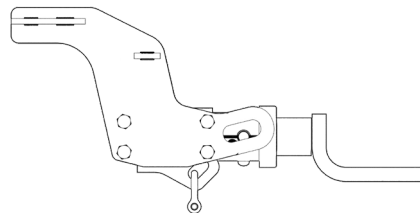
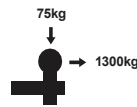

**TAG XR**

TXR817



5 Door

## 4x4 Recovery SUV

(12/2023 - on)

- 65mm x 65mm Extreme Duty Reinforced Crossbar
- Two WLL 2000kg Load-Rated Recovery Points
- Maximum clearance for departure angles.
- Textured Extreme Duty Powder Coated Finish
- Dual top-mounted Trailer & Anderson Plug Mounts
- TAG Limited Lifetime Warranty
- Includes Zinc Tow Ball & Extreme Duty Drop Hitch, Pin & Clip and D-Shackles

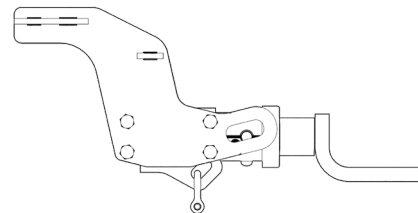
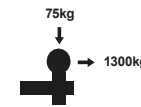

**TAG XR**

# Toyota Hiace / Commuter

25

T7T709



## Heavy Duty (1-Piece)

### Van

(02/2019 - on)

- 3-Piece Design
- Factory Mounting Points for ease of fitment
- Durable Powder Coated Finish
- Class 4, 50mm x 50mm Hitch Receiver
- TAG Limited Lifetime Warranty
- Includes Tow Ball, Tow Ball Mount, Pin & Clip and D-Shackles

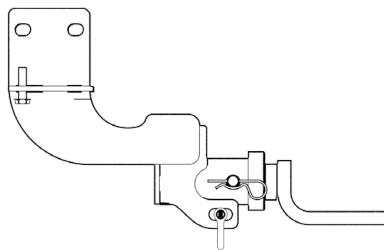
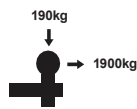

**TAG**

T7T743-K010



## Towbar & Rear Step

### Van

(02/2019 - on)

- 3-Piece Design
- Factory Mounting Points for ease of fitment
- Bolt-on Galvanised Rear Step
- Sensor Bracket Kit
- Powder Coated Towbar and Brackets
- Class 4, 50mm x 50mm Hitch Receiver
- TAG Limited Lifetime Warranty
- Includes Tow Ball, Tow Ball Mount, Pin & Clip and D-Shackles

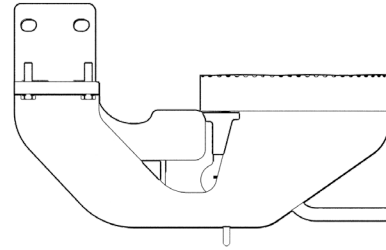
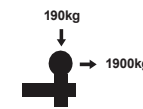

**TAG**

TST751-K010



## Rear Step

### Van

(02/2019 - on)

- Bolt-on Galvanised Rear Step
- Sensor Bracket Kit
- Heavy-Duty Powder-Coated Brackets
- 250kg Static Load Rating
- TAG Limited Lifetime Warranty

T7T701



No Bumper

## Heavy Duty (3-Piece) Styleside / Cab Chassis (04/2005 - on)

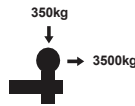

- 3-Piece Design
- Factory Mounting Points for ease of fitment
- Durable Powder Coated Finish
- Class 4, 50mm x 50mm Hitch Receiver
- TAG Limited Lifetime Warranty
- Includes Tow Ball, Tow Ball Mount, Pin & Clip and D-Shackles

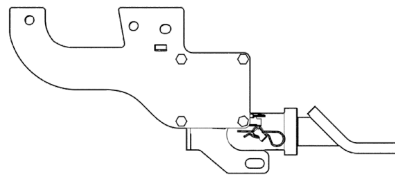

**TAG**

T7T703



## Heavy Duty (3-Piece) Extended Tray (04/2005 - on)

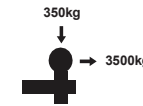

- 3-Piece Design (Suits Extended Tray or Canopy)
- Class 4, 50mm x 50mm Hitch Receiver
- Durable Powder Coated Finish
- TAG Limited Lifetime Warranty
- Includes Tow Ball, Tow Ball Mount, Pin & Clip and D-Shackles

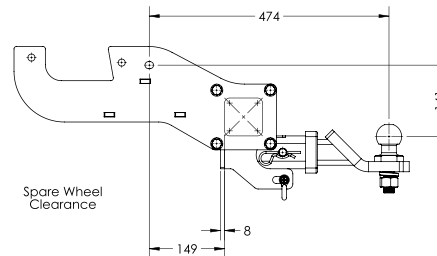

**TAG**

T7T715



## Heavy Duty (3-Piece) Styleside Ute (10/2015 - on)

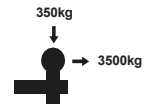

- 3-Piece Design
- Factory Mounting Points for ease of fitment
- Durable Powder Coated Finish
- Class 4, 50mm x 50mm Hitch Receiver
- TAG Limited Lifetime Warranty
- Includes Tow Ball, Tow Ball Mount, Pin & Clip and D-Shackles

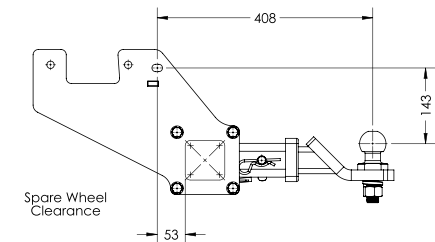

**TAG**

TXR783



## 4x4 Recovery Cab Chassis

(07/2015 - on)

- 89mm x 89mm Extreme Duty Reinforced Crossbar
- Two WLL 4500kg Load-Rated Recovery Points
- Maximum clearance for departure angles.
- Textured Extreme Duty Powder Coated Finish
- Dual top-mounted Trailer & Anderson Plug Mounts
- TAG Limited Lifetime Warranty
- Includes Zinc Tow Ball & Extreme Duty Drop Hitch, Pin & Clip and D-Shackles

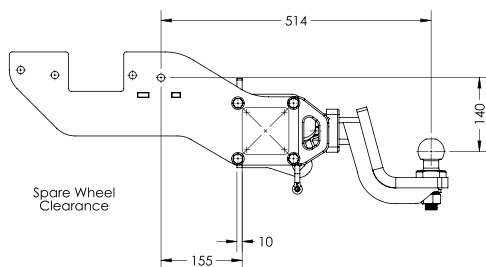

**TAG XR**

TXR819



## 4x4 Recovery Styleside Ute

(10/2015 - on)

- Extreme Duty Reinforced Crossbar
- Two WLL 4000kg Load-Rated Recovery Points
- Maximum clearance for departure angles.
- Textured Extreme Duty Powder Coated Finish
- Dual Trailer & Anderson Plug Mounts
- TAG Limited Lifetime Warranty
- Includes Tow Ball, Tow Ball Mount, Pin & Clip and D-Shackles

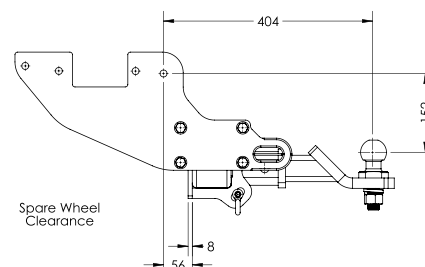

**TAG XR**

# Toyota Landcruiser 78 Series / 300 Series

28

TXR862



## 4x4 Recovery

### Troop Carrier

(08/1991 - on)

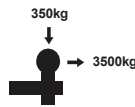

- Extreme Duty Reinforced Crossbar
- Two WLL 4000kg Load-Rated Recovery Points
- Maximum clearance for departure angles.
- Textured Extreme Duty Powder Coated Finish
- Dual Trailer & Anderson Plug Mounts
- TAG Limited Lifetime Warranty
- Includes Tow Ball, Tow Ball Mount, Pin & Clip and D-Shackles

**TAG XR**

TKT864



300 Series

## Tow Ball Mount Kit

### Wagon

(09/2022 - on)

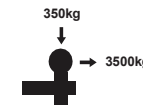

- Durable Powder-Coated Finish
- 219mm Long (Hitch Pin Hole to Tow Ball Hole)
- 105° Tongue Face
- Drop: 63mm
- Can be mounted in Drop Mode Only
- 50mm Chrome Tow Ball
- Extra Long Class 4 Pin & Clip
- Backing Plate to fit 7 Pin Flat Connector
- TAG Limited Lifetime Warranty

**TAG HD**



# Toyota Landcruiser 79 Series

29

T7T699



## Heavy Duty (3-Piece) Styleside / Cab Chassis (08/2012 - on)

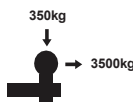

- 3-Piece Design
- Factory Mounting Points for ease of fitment
- Durable Powder Coated Finish
- Class 4, 50mm x 50mm Hitch Receiver
- TAG Limited Lifetime Warranty
- Includes Tow Ball, Tow Ball Mount, Pin & Clip and D-Shackles

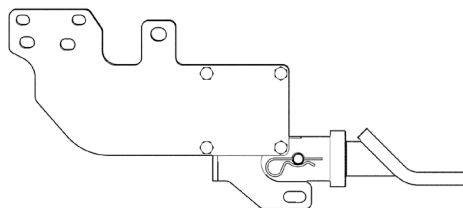

**TAG HD**

TXR793



## 4x4 Recovery Cab Chassis (08/2012 - on)

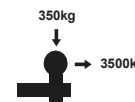

- 89mm x 89mm Extreme Duty Reinforced Crossbar
- Two WLL 4500kg Load-Rated Recovery Points
- Maximum clearance for departure angles.
- Textured Extreme Duty Powder Coated Finish
- Dual top-mounted Trailer & Anderson Plug Mounts
- TAG Limited Lifetime Warranty
- Includes Zinc Tow Ball & Extreme Duty Drop Hitch, Pin & Clip and D-Shackles

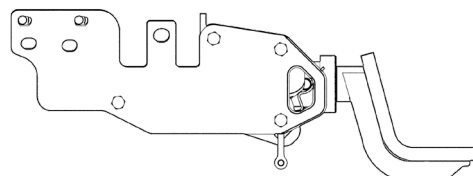

**TAG XR**

TMR812



## Mine Spec with Pintle Cab Chassis (08/2012 - on)

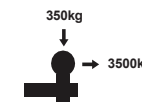

- 89mm x 89mm Extreme Duty Reinforced Crossbar
- Two WLL 4500kg Load-Rated Recovery Points
- Maximum clearance for departure angles.
- Textured Extreme Duty Powder Coated Finish
- Dual top-mounted Trailer & Anderson Plug Mounts
- TAG Limited Lifetime Warranty
- Includes Zinc Tow Ball & Pintle, Pin & Clip and D-Shackles

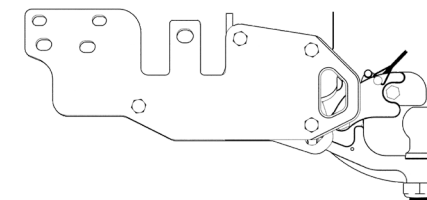

**TAG MR**

# Toyota Prado / RAV4

30

T7T728



Prado (Spare Wheel Underneath)

## Heavy Duty (3-Piece)

Styleside Ute

(08/2009 - on)

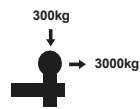

- 3-Piece Design
- Factory Mounting Points for ease of fitment
- Durable Powder Coated Finish
- Class 4, 50mm x 50mm Hitch Receiver
- TAG Limited Lifetime Warranty
- Includes Tow Ball, Tow Ball Mount, Pin & Clip and D-Shackles

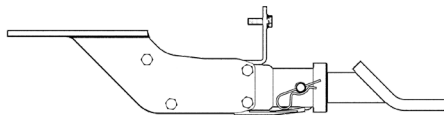

**TAG HD**

T7T729



Prado

## Heavy Duty (3-Piece)

Styleside / Cab Chassis

(09/2002 - on)

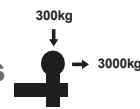

- 3-Piece Design
- Factory Mounting Points for ease of fitment
- Durable Powder Coated Finish
- Class 4, 50mm x 50mm Hitch Receiver
- TAG Limited Lifetime Warranty
- Includes Tow Ball, Tow Ball Mount, Pin & Clip and D-Shackles

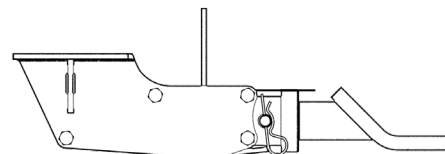

**TAG HD**

TXR818



Prado

## 4x4 Recovery

Cab Chassis

(08/2009 - on)

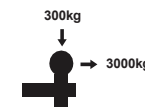

- Does not fit with a spare wheel under the vehicle
- Factory Mounting Points for ease of fitment
- Two WLL 4000kg Load-Rated Recovery Points
- Textured Extreme Duty Powder Coated Finish
- Dual top-mounted Trailer & Anderson Plug Mounts
- Class 4, 50mm x 50mm Hitch Receiver
- TAG Limited Lifetime Warranty
- Includes Tow Ball Mount, Zinc Tow Ball, Pin & Clip and D-Shackles

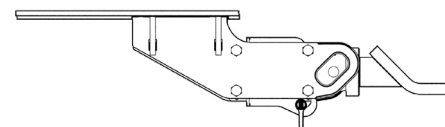

**TAG XR**

T7T798



RAV4

## Heavy Duty (3-Piece)

Styleside Ute

(01/2019 - on)

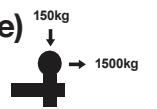

- 3-Piece Design
- Factory Mounting Points for ease of fitment
- Durable Powder Coated Finish
- Class 4, 50mm x 50mm Hitch Receiver
- TAG Limited Lifetime Warranty
- Includes Tow Ball, Tow Ball Mount, Pin & Clip and D-Shackles

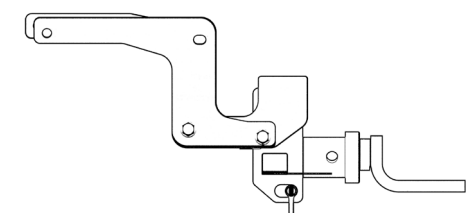

**TAG HD**

# Volkswagen Amarok

31

T7P673



## Heavy Duty (1-Piece)

### Styleside Ute

(02/2011 - 07/2022)

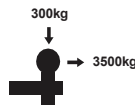

- For Factory Rear Step
- Factory Mounting Points for ease of fitment
- Durable Powder Coated Finish
- Class 4, 50mm x 50mm Hitch Receiver
- TAG Limited Lifetime Warranty
- Includes Tow Ball, Tow Ball Mount, Hitch Pin & R-Clip and D-Shackles

**TAG HD**

TXR807



## 4x4 Recovery

### Cab Chassis

(09/2011 - 12/2022)

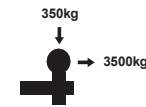

- 89mm x 89mm Extreme Duty Reinforced Crossbar
- Two WLL 4500kg Load-Rated Recovery Points
- Maximum clearance for departure angles.
- Textured Extreme Duty Powder Coated Finish
- Dual top-mounted Trailer & Anderson Plug Mounts
- TAG Limited Lifetime Warranty
- Includes Zinc Tow Ball & Extreme Duty Drop Hitch, Pin & Clip and D-Shackles

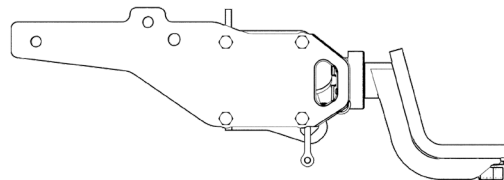

**TAG XR**

# Volkswagen Transporter

32

T7P725



## Heavy Duty (3-Piece)

### Van

(04/2003 - on)

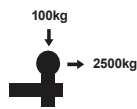

- 3-Piece Design
- Factory Mounting Points for ease of fitment
- Durable Powder Coated Finish
- Class 4, 50mm x 50mm Hitch Receiver
- TAG Limited Lifetime Warranty
- Includes Tow Ball, Tow Ball Mount, Pin & Clip and D-Shackles

**TAG**

T7P738-K010



## Towbar & Rear Step

### Van

(04/2003 - 06/2020)

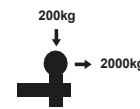

- 3-Piece Design
- Factory Mounting Points for ease of fitment
- Bolt-on Galvanised Rear Step
- Sensor Bracket Kit
- Powder Coated Towbar and Brackets
- Class 4, 50mm x 50mm Hitch Receiver
- TAG Limited Lifetime Warranty
- Includes Tow Ball, Tow Ball Mount, Pin & Clip and D-Shackles

**TAG**

TSP746-K010



## Rear Step

### Van

(03/2010 - on)

- Bolt-on Galvanised Rear Step
- Sensor Bracket Kit
- Heavy-Duty Powder-Coated Brackets
- 250kg Static Load Rating
- TAG Limited Lifetime Warranty